

DCL 11, DCL 12 EN 3

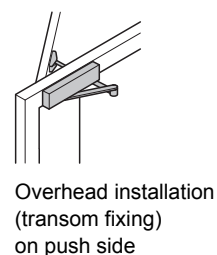
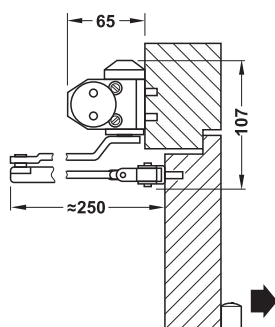
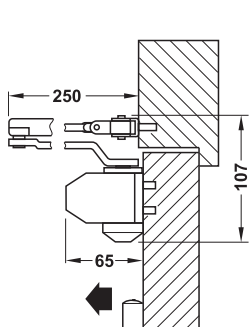
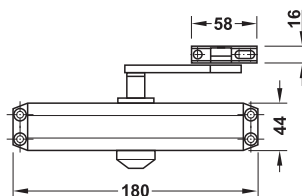

5

Fire resistance and smoke control

F Tested for fire resistant and smoke control doors.

X The use of a hold open device on fire resistant and smoke control doors is not permitted.

- Version: Optionally with standard arm or interlocking hold open arm
- Installation: Suitable for standard installation on pull side and overhead installation on push side
- Adjustment facility: Closing speed continuously adjustable, backcheck adjustable, latching action continuously adjustable
- Closing force: 3
- Door width: ≤950 mm
- Opening angle: ≤180°
- Hold open angle: ≤145°
- Mounting: For DIN left hand and DIN right hand use
- Standard: DCL 11 certified in compliance with EN 1154:1996/A1:2002
- Class:

4	8	3	1	1	3
---	---	---	---	---	---

Supplied with

Door closer complete with arm

		Silver coloured
DCL 11 set		
1 DCL 11 with standard arm	F	931.84.649
DCL 12 set		
1 DCL 12 with hold open arm	X	931.84.659